



Miami-Dade County Public Schools

giving our students the world

Superintendent of Schools
Dr. Jose L. Dotres

Miami-Dade County School Board
Mari Tere Rojas, Chair
Monica Colucci, Vice Chair
Roberto J. Alonso
Lucia Baez-Geller
Dr. Dorothy Bendross-Mindingall
Mary Blanco
Danny Espino
Dr. Steve Gallon III
Luisa Santos

Boundary Change-Final Targeted School December 13, 2023

Dear Parents:

We want to inform you of changes that have been proposed for this school's attendance boundaries for the 2024-2025 school year. The students, who may be affected, live within the area(s) identified on the attached map.

To ensure that you, as parents, have all the information you need concerning these proposed recommendations, and to allow you to ask any questions you may have about these proposed changes, we have scheduled a special meeting to discuss this matter with you. This meeting will take place as follows:

Date: January 10, 2024
Time: 6 p.m.
Location: Parkview Elementary School
17631 NW 20th Avenue
Miami Gardens, FL 33056
Room: Cafetorium

The entire proposed boundary recommendation is posted on our website, crestviewelem.net, and on the school's bulletin board.

If you have any other questions, please contact your school principal at (305) 624-1495.

Sincerely,

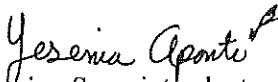
Yesenia Aponte
Region Superintendent

Principal

Map Attached

cc: Dr. John D. Pace, III
Ms. Tracie N. Abner
Mr. Ronald G. Redmon

Crestview Elementary
2201 NW 187th Street
Miami Gardens, FL 33056

Parkview Elementary
17631 NW 20th Avenue
Miami Gardens, FL 33056

Scott Lake Elementary
1160 NW 175th Street
Miami Gardens, FL 33169

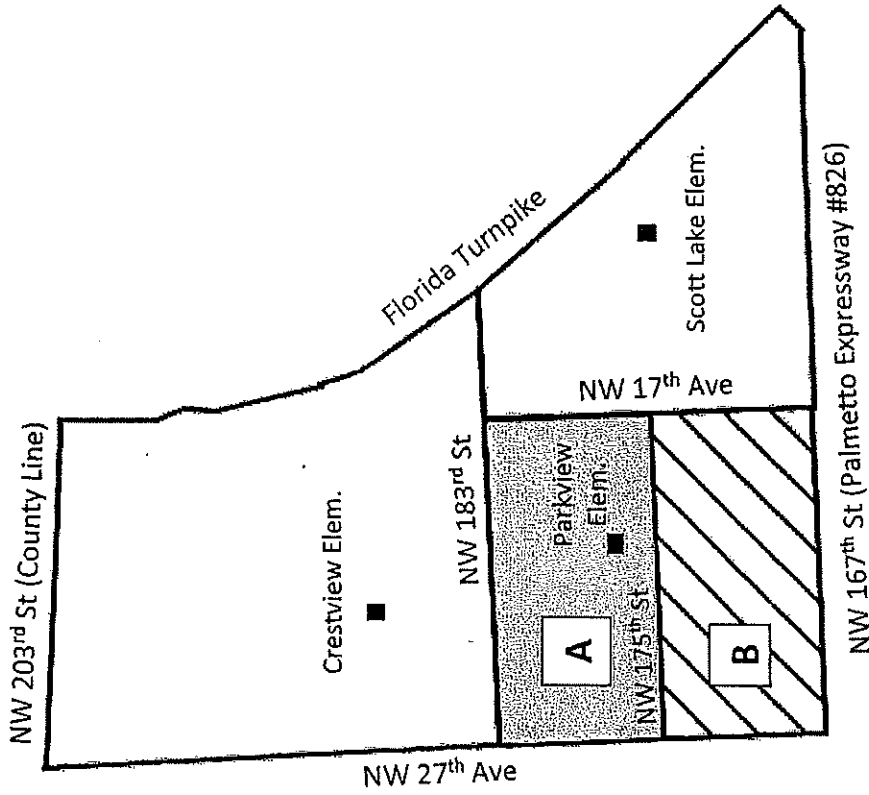

A & B

A

B

Areas A and B represent the current boundary for Parkview Elementary.

Area to be assigned from Parkview Elementary to Crestview Elementary.

Area to be assigned from Parkview Elementary to Scott Lake Elementary.



Miami-Dade County Public Schools

giving our students the world

Superintendent of Schools
Dr. Jose L. Dotres

Miami-Dade County School Board

Mari Tere Rojas, Chair
Monica Colucci, Vice Chair
Roberto J. Alonso
Lucia Baez-Geller
Dr. Dorothy Bendross-Mindingall
Mary Blanco
Danny Espino
Dr. Steve Gallon III
Luisa Santos

Boundary Change-Final Targeted School December 13, 2023

Estimados padres de familia:

Por este medio les notifico los cambios propuestos para las zonas de asistencia escolar de esta escuela para el curso escolar de 2024-2025. Los estudiantes a los que se pudiera trasladar, residen dentro de la/s área/s identificada(s) en el mapa adjunto.

A fin de garantizar que ustedes, como padres de familia, conozcan todos los detalles que necesitan saber en cuanto a dichas recomendaciones y darles la oportunidad de formular cualquier pregunta que pudieran tener en cuanto a los mismos, hemos programado una reunión especial para discutir este asunto con ustedes. La reunión se celebrará según se consigna a continuación:

Fecha: January 10, 2024
Horario: 6 p.m.
Lugar: Parkview Elementary School
17631 NW 20th Avenue
Miami Gardens, Fl 33056
Aula: Cafetorium

La recomendación para los límites de la zona de asistencia escolar aparece en nuestro sitio "web", crestviewelem.net y en el tablero de anuncios de la escuela.

Si tienen otras preguntas, por favor, comuníquese con el/la director/a de la escuela llamando al (305) 624-1495.

Atentamente,

Superintendente de la Región

Directora

Mapa adjunto

cc: Dr. John D. Pace, III
Ms. Tracie N. Abner
Mr. Ronald G. Redmon

Crestview Elementary
2201 NW 187th Street
Miami Gardens, FL 33056

Parkview Elementary
17631 NW 20th Avenue
Miami Gardens, FL 33056

Scott Lake Elementary
1160 NW 175th Street
Miami Gardens, FL 33169

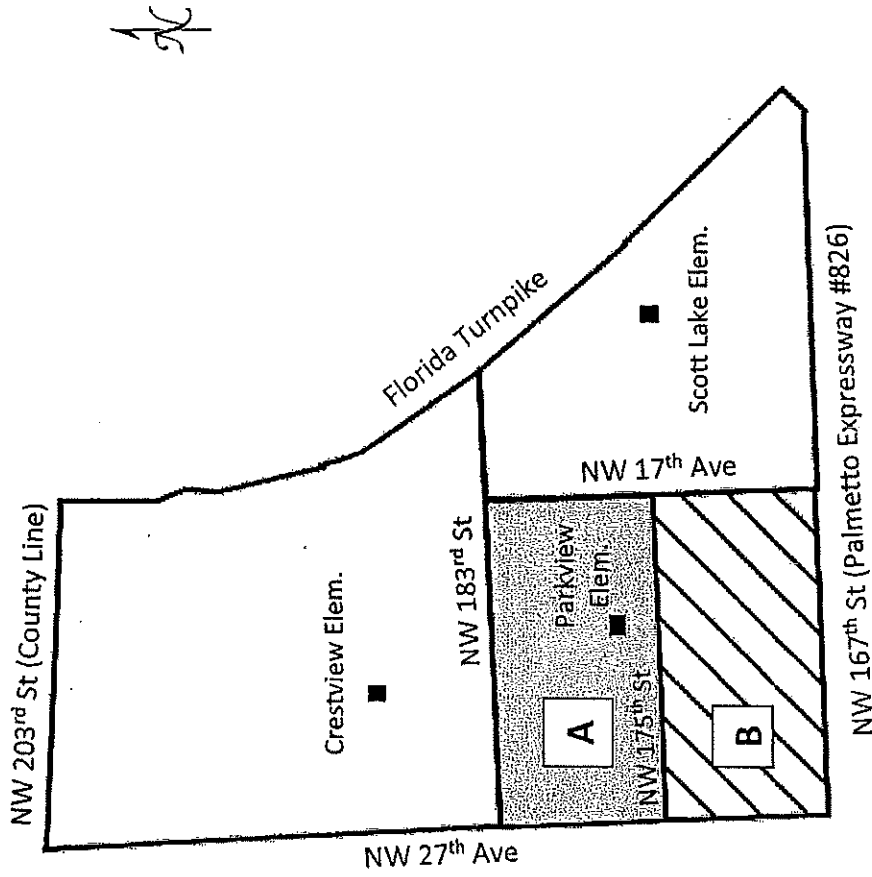

A & B

A

B

Areas A and B represent the current boundary for Parkview Elementary.

Area to be assigned from Parkview Elementary to Crestview Elementary.

Area to be assigned from Parkview Elementary to Scott Lake Elementary.



Miami-Dade County Public Schools

giving our students the world

Superintendent of Schools
Dr. Jose L. Dotres

Miami-Dade County School Board
Mari Tere Rojas, Chair
Monica Colucci, Vice Chair
Roberto J. Alonso
Lucia Baez-Geller
Dr. Dorothy Bendross-Mindingall
Mary Blanco
Danny Espino
Dr. Steve Gallon III
Luisa Santos

Boundary Change-Final Targeted School December 13, 2023

Chè Paran,

Nou vle enfòmasyon sou chanjman ki te pwopoze pou limit prezans lekòl sa a pou ane lekòl 2024-2025 la. Elèv yo kab deplase yo, abite nan zòn yo idantifye sou kat jewografi ki atache a.

Pou asire oumenm kòm paran, genyen tout enfòmasyon ou bezwen konsènan rekòmandasyon ki te pwopoze a, e pou pèmèt ou poze nenpòt kesyon ou kab genyen sou chanjman ki te pwopoze yo, nou gen nan orè nou pou fè yon reyinyon espesyal pou diskite sou sijè sa a ak ou. Reyinyon sa a ap fèt jan sa site anba a:

Dat: January 10, 2024
Le: 6 p.m.
Lokasyon: Parkview Elementary School
17631 NW 20th Avenue
Miami Gardens, FL 33056
Chanm: Cafetorium

Tout rekòmandasyon limit ki te pwopoze a afiche sou paj Entènèt nou an, crestviewelem.net, e sou afich bilten lekòl la.

Si w gen nenpòt lòt kesyon, silvouplè kontakte direktè (tris) lekòl la nan (305) 624-1495.

Sensèman,

Sipèentandan Rejyon

Direktè (tris)

Kat Jewografi a atach

cc: Dr. John D. Pace, III
Ms. Tracie N. Abner
Mr. Ronald G. Redmon

Crestview Elementary
2201 NW 187th Street
Miami Gardens, FL 33056

Parkview Elementary
17631 NW 20th Avenue
Miami Gardens, FL 33056

Scott Lake Elementary
1160 NW 175th Street
Miami Gardens, FL 33169

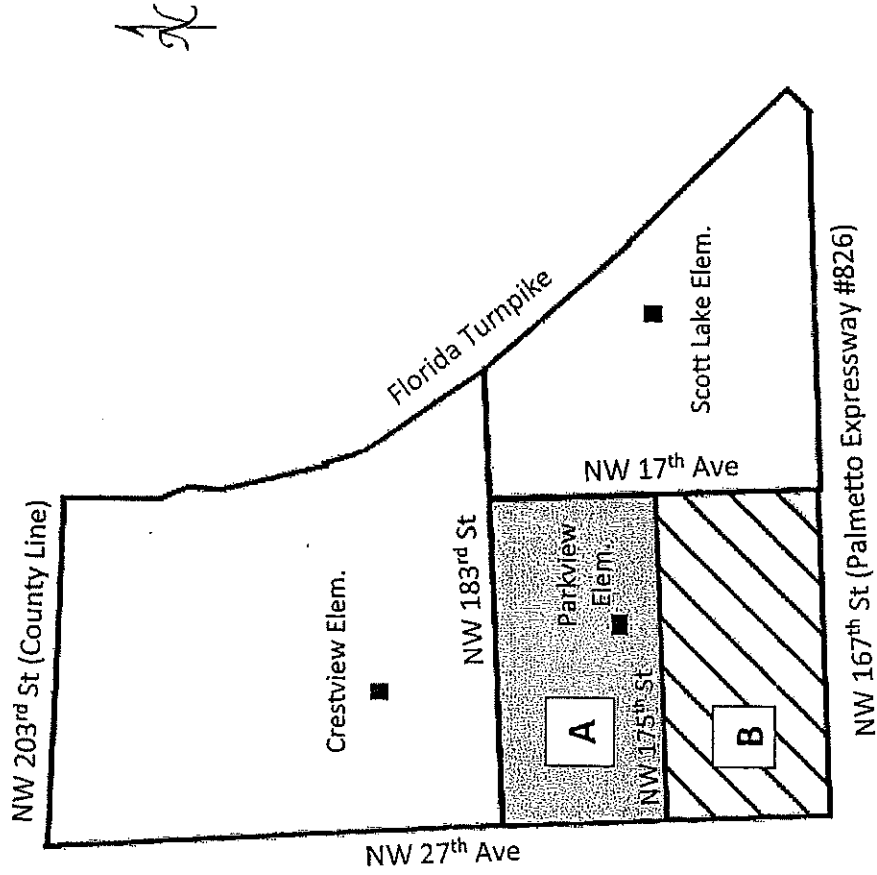

A & B

A

B

- Areas A and B represent the current boundary for Parkview Elementary.
- Area to be assigned from Parkview Elementary to Crestview Elementary.
- Area to be assigned from Parkview Elementary to Scott Lake Elementary.